



Tarrant County

LAW ENFORCEMENT TRAINING CENTER STUDY



Overview

- Goals
- Options
- Costs



Goals

- Incorporate current and future needs
- Adequate training spaces
- Enhance recruitment
- Good stewardship of County budget & funds
- Academy-style use for Tarrant & Regional Law Enforcement Agencies

Considerations/Options/Costs

- Reduced Scope
- Site Options
- Costs
- Envisioned Project



Information Gathering

- QUESTIONNAIRES
- SPACE STANDARDS
- ANALYSIS
- ADJACENCIES
- ESTIMATES

Tarrant County Law Enforcement Training Center Study Programming Questionnaire

1. Do you see facility as single building with central lobby with connection to major functions or campus approach of multiple buildings accommodating separate functions? Multiple buildings may result in duplication of building functions such as toilet rooms, electrical, janitor closets, etc.
2. Do you anticipate separate access to site for student (open access) versus training functions (controlled access).
3. Do you want to be grouped by functions? Please review and confirm if anticipated functional groupings assigned below are appropriate.
 - a. Building/general functions
 - i. Lobby
 - ii. Auditorium/Graduation Room
 - iii. Public toilets
 - iv. Student toilets
 - v. Unisex toilet
 - vi. Break room students
 - vii. TCOLE library
 - viii. Classrooms
 - ix. Instructor offices
 - x. General and instructor storage rooms
 - xi. Weight/Functional room
 - xii. Building functional rooms
 1. Janitor closet
 2. HVAC/Elec closets
 3. IT/Data
 4. Fire sprinkler closet
 - xiii. Heritage/Memorial room
 - xiv. Circulation and building factor
 - b. Recruiting offices and spaces
 - i. Computer testing
 - ii. Recruiting offices
 - iii. Storage room
 - iv. Briefing room/new hire
 - c. Administrative offices and spaces
 - i. Please provide current and anticipated staff/law enforcement personnel counts to be accommodated within facility.
 - ii. Copier room
 - iii. Background investigation offices
 - iv. Sgt offices
 1. Storage
 - v. Capt. Office
 1. Storage

Information Gathering

- QUESTIONNAIRES
- SPACE STANDARDS
- ANALYSIS
- ADJACENCIES
- ESTIMATES

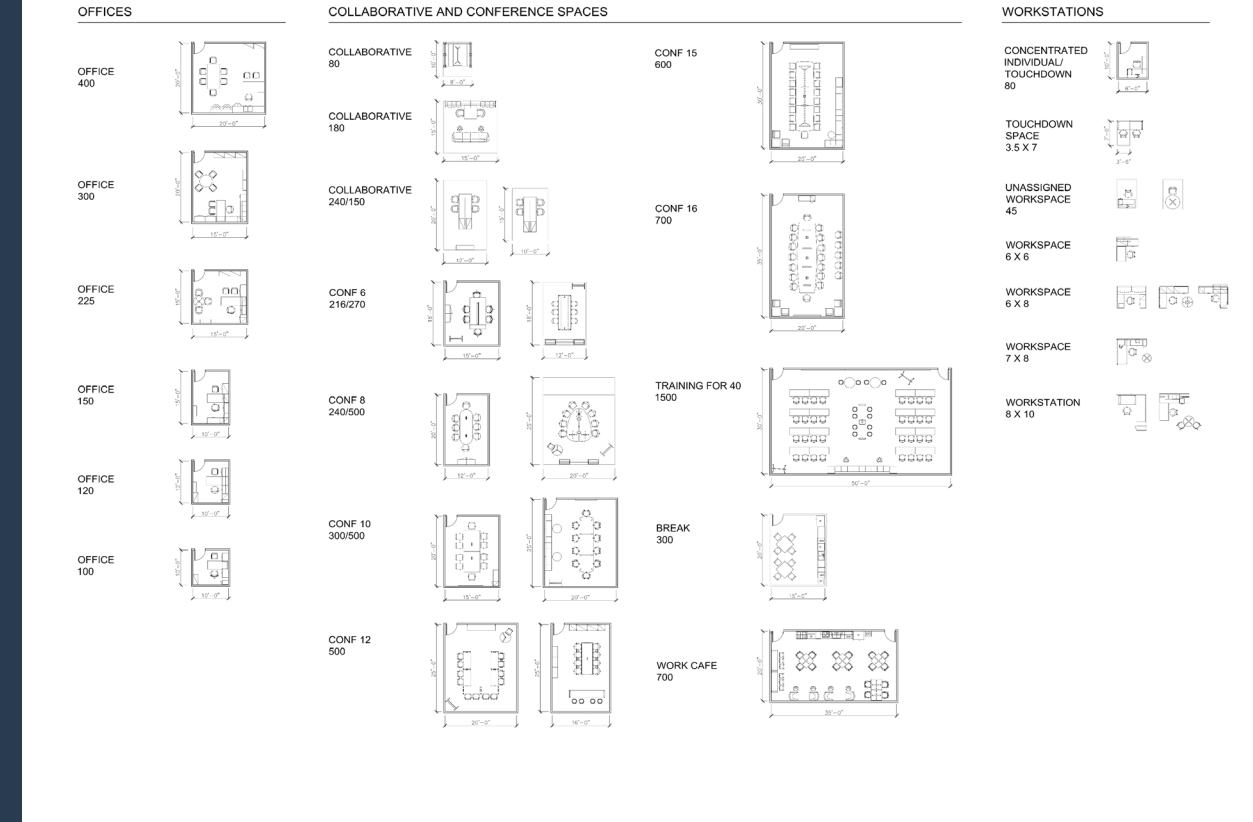

- QUESTIONNAIRES
- SPACE STANDARDS
- **ANALYSIS**
- ADJACENCIES
- ESTIMATES



KOMATSU
ARCHITECTURE

Information Gathering

- QUESTIONNAIRES
- SPACE STANDARDS
- ANALYSIS
- ADJACENCIES
- ESTIMATES

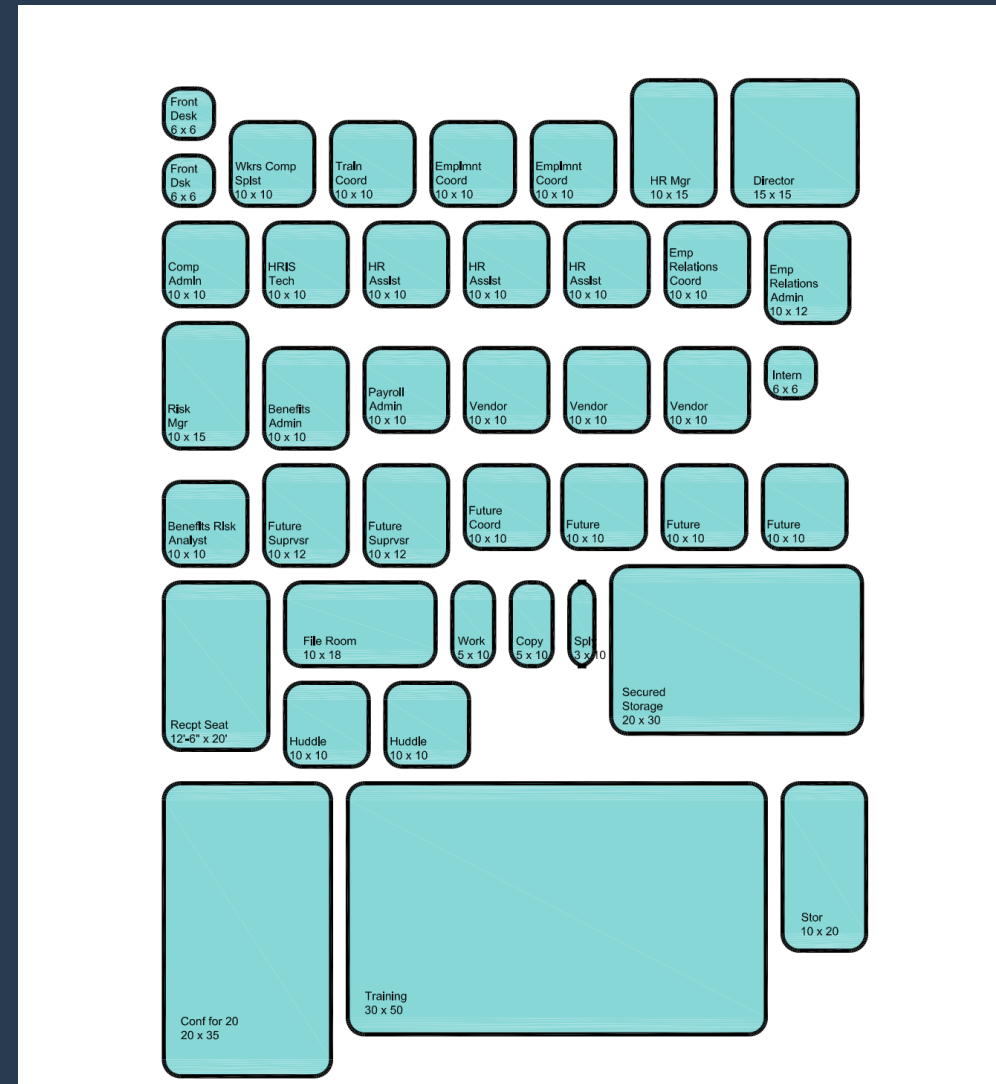

Information Gathering

- QUESTIONNAIRES
- SPACE STANDARDS
- ANALYSIS
- **ADJACENCIES**
- ESTIMATES

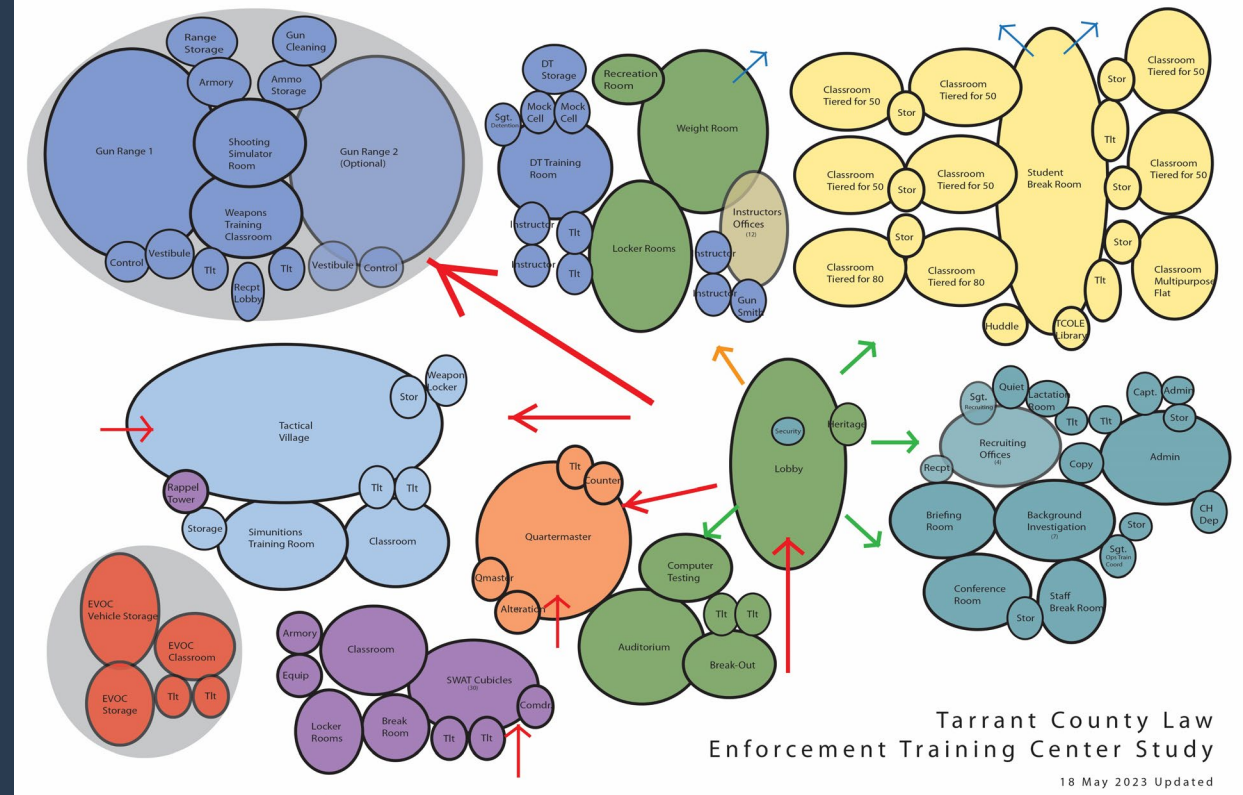

Information Gathering

- QUESTIONNAIRES
- SPACE STANDARDS
- ANALYSIS
- ADJACENCIES
- **ESTIMATES**



A large, modern conference room with a U-shaped table and many chairs. The room has a high ceiling with recessed lighting and two large projection screens at the front. The floor is covered in a patterned carpet. The room is empty, with no people present.

Project Options

PROGRAMS BASED ON COUNTY PARAMETERS

Option 1

RESOURCE CONNECTION

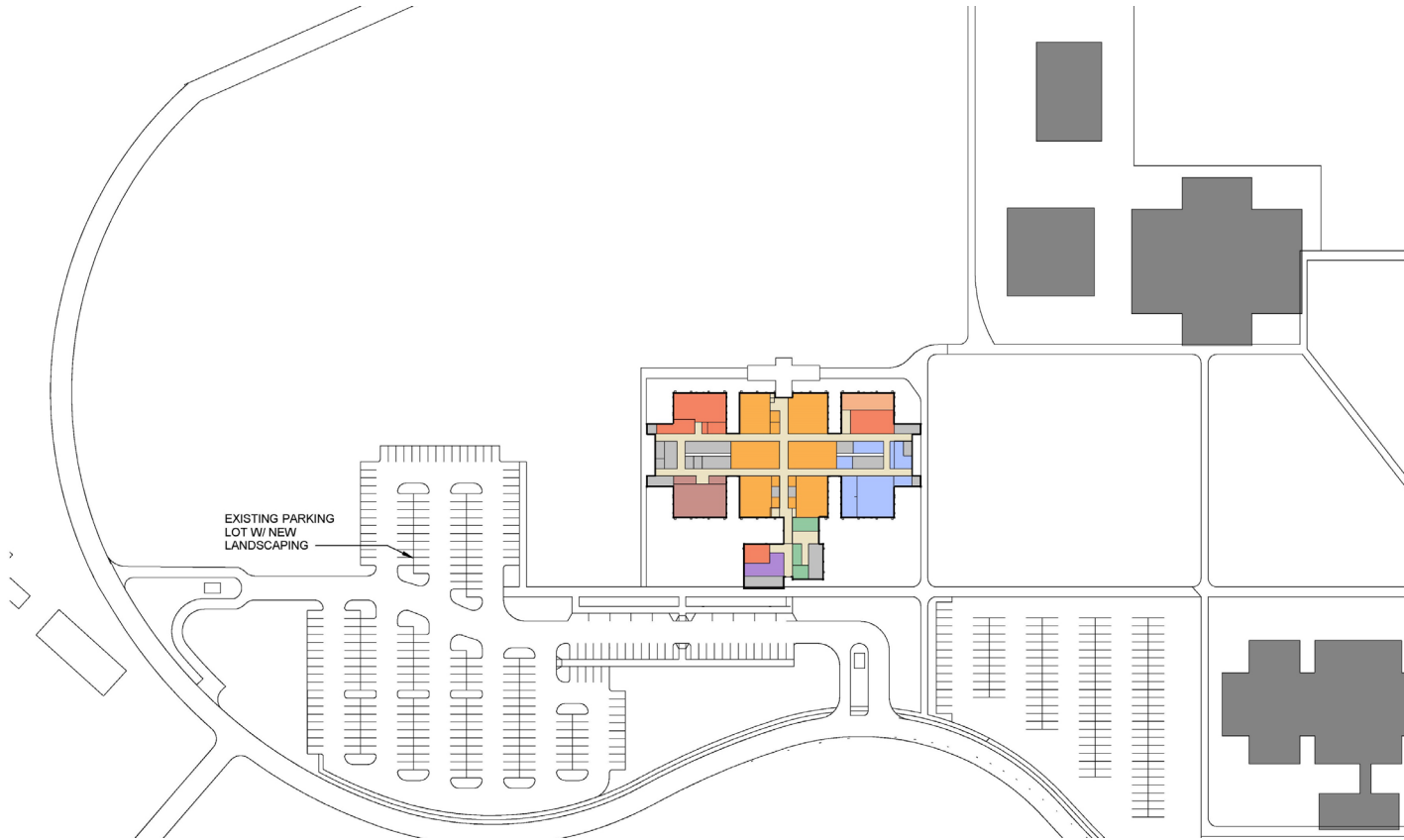

- **Main functions within renovated existing building**

Option 1

RESOURCE CONNECTION

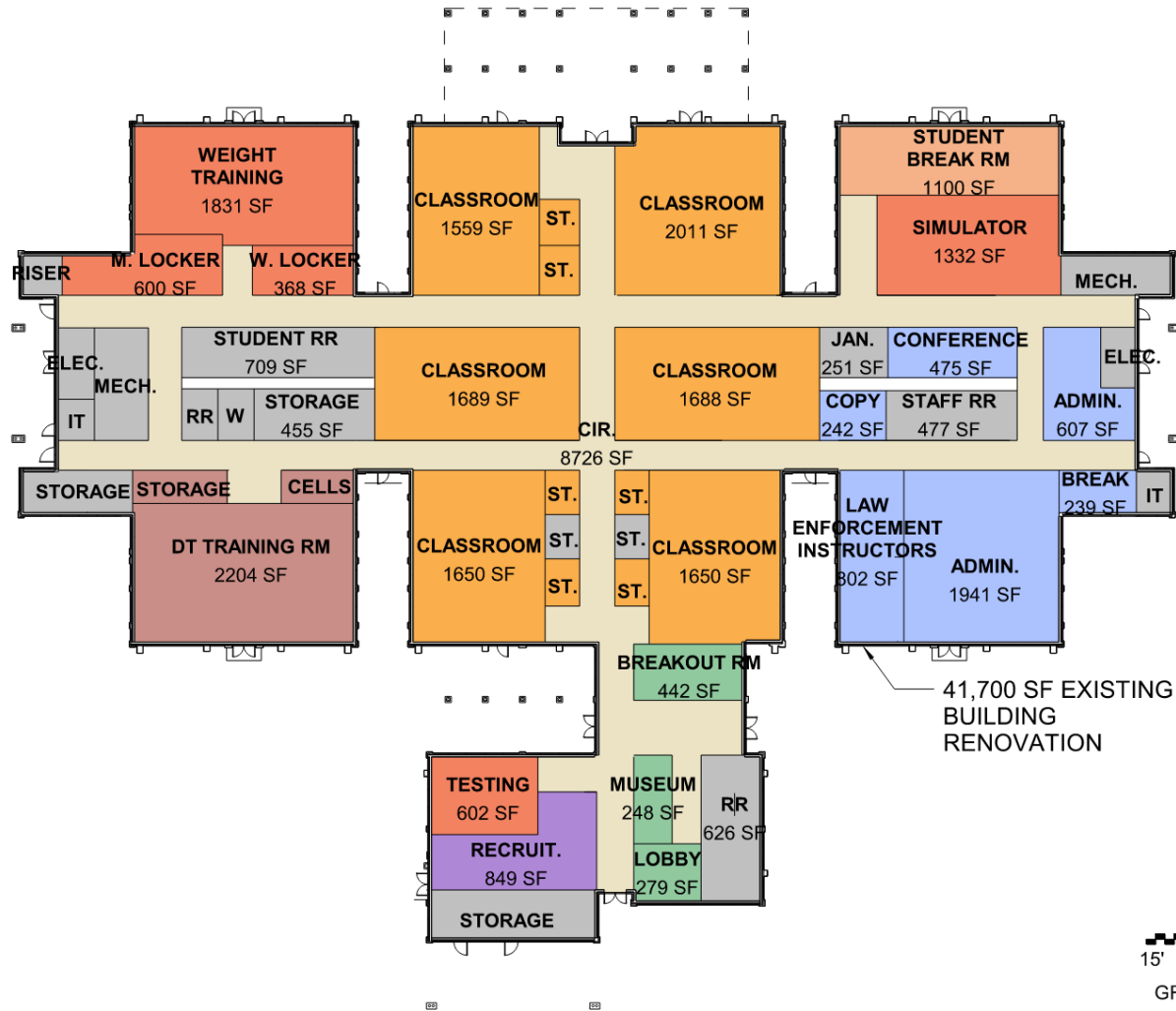

- Existing Building 1500 41,700 sf

Option 1 – Range Building Shooting Range

LOCATED AT TCC NW CAMPUS

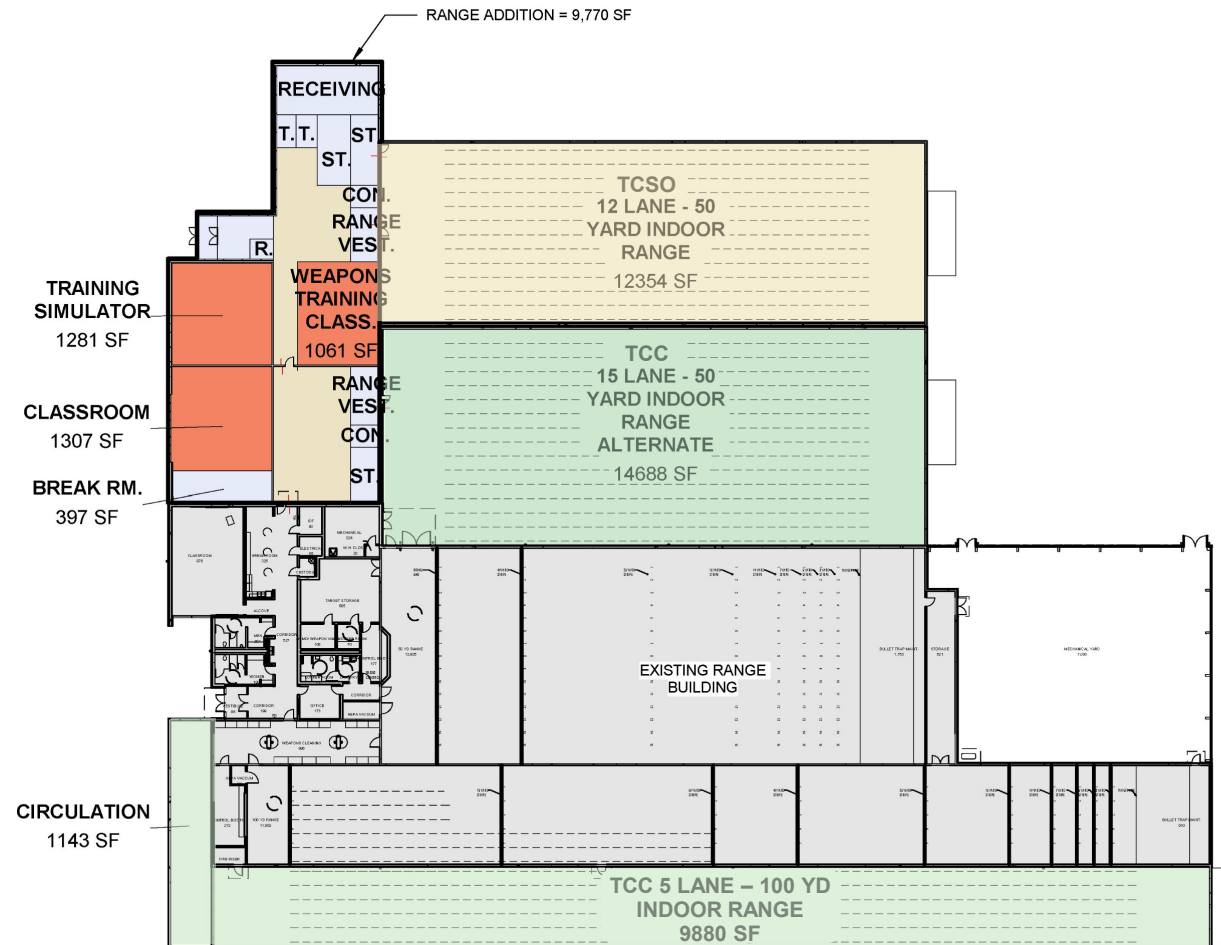

- Range building addition 9,770 sf
- Potential future indoor ranges

Option 1

RESOURCE CONNECTION



Option 1

RESOURCE CONNECTION

LAW ENFORCEMENT TRAINING CENTER

STILL WAITING FOR IMAGE!



ALTERNATE EXTERIOR ENHANCEMENT

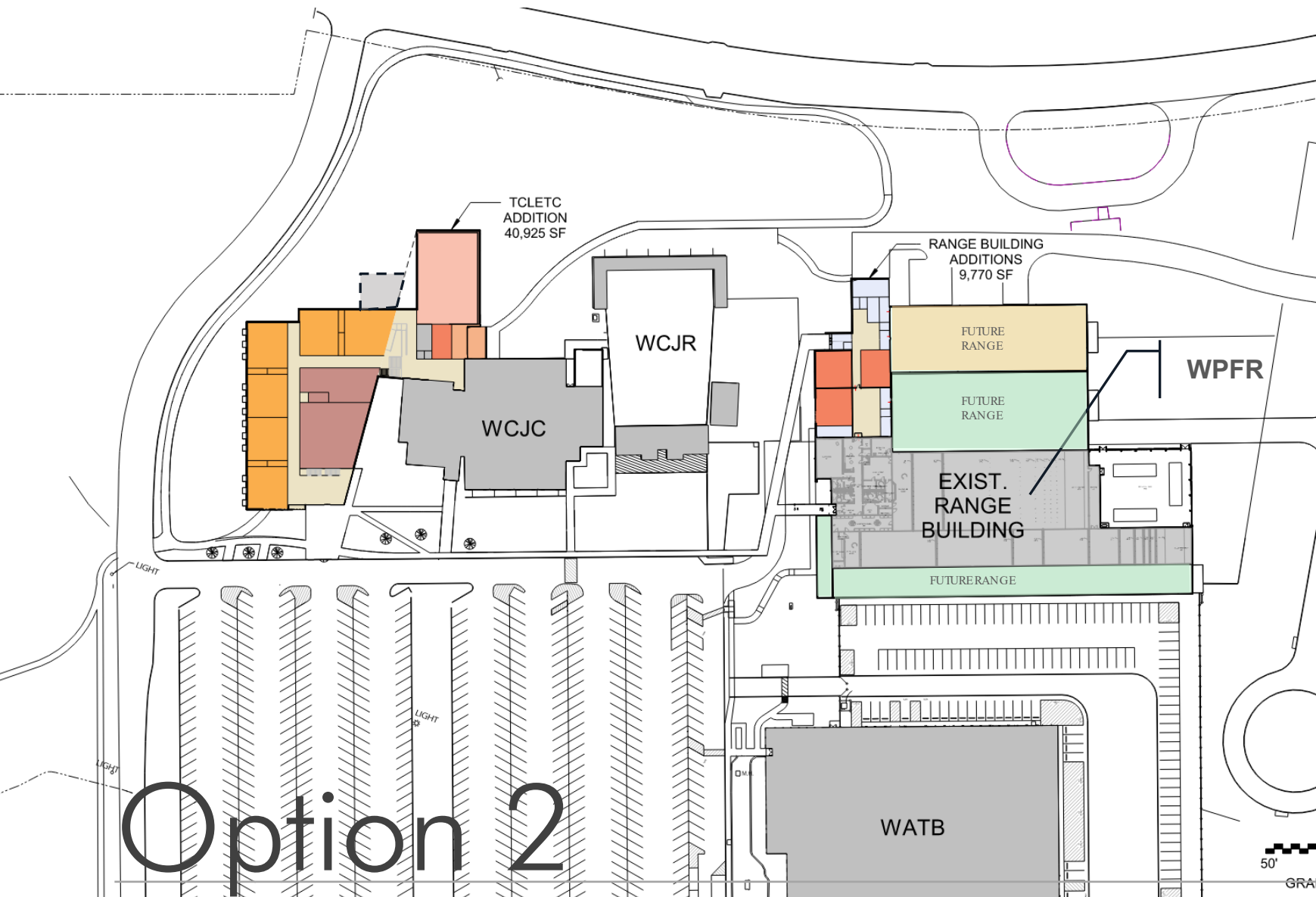

Option 2

MAIN TCSO BUILDING ADDITION TO TCC BUILDING

- Main Building addition to existing TCC building
- Future range addition to existing TCC building

Option 2

MAIN TCSO BUILDING ADDITION TO TCC BUILDING

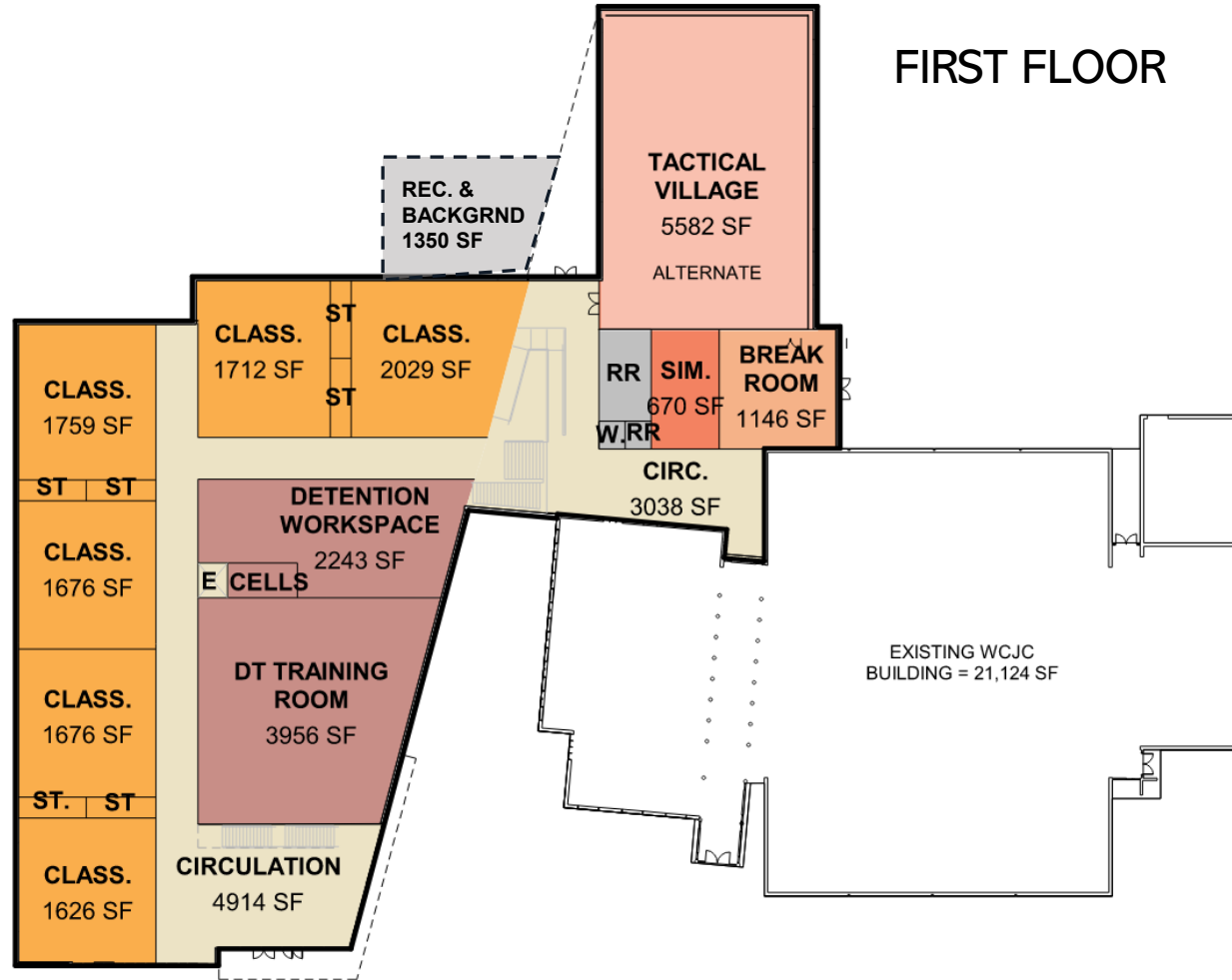

- Main TCSO Building is 2 levels
- Total 40,925 sf
- Tactical Village as alternate
- Addition to existing TCC WCJC building
- Recruiter & Background Investigators as alternate

Option 2

MAIN TCSO BUILDING ADDITION TO TCC BUILDING

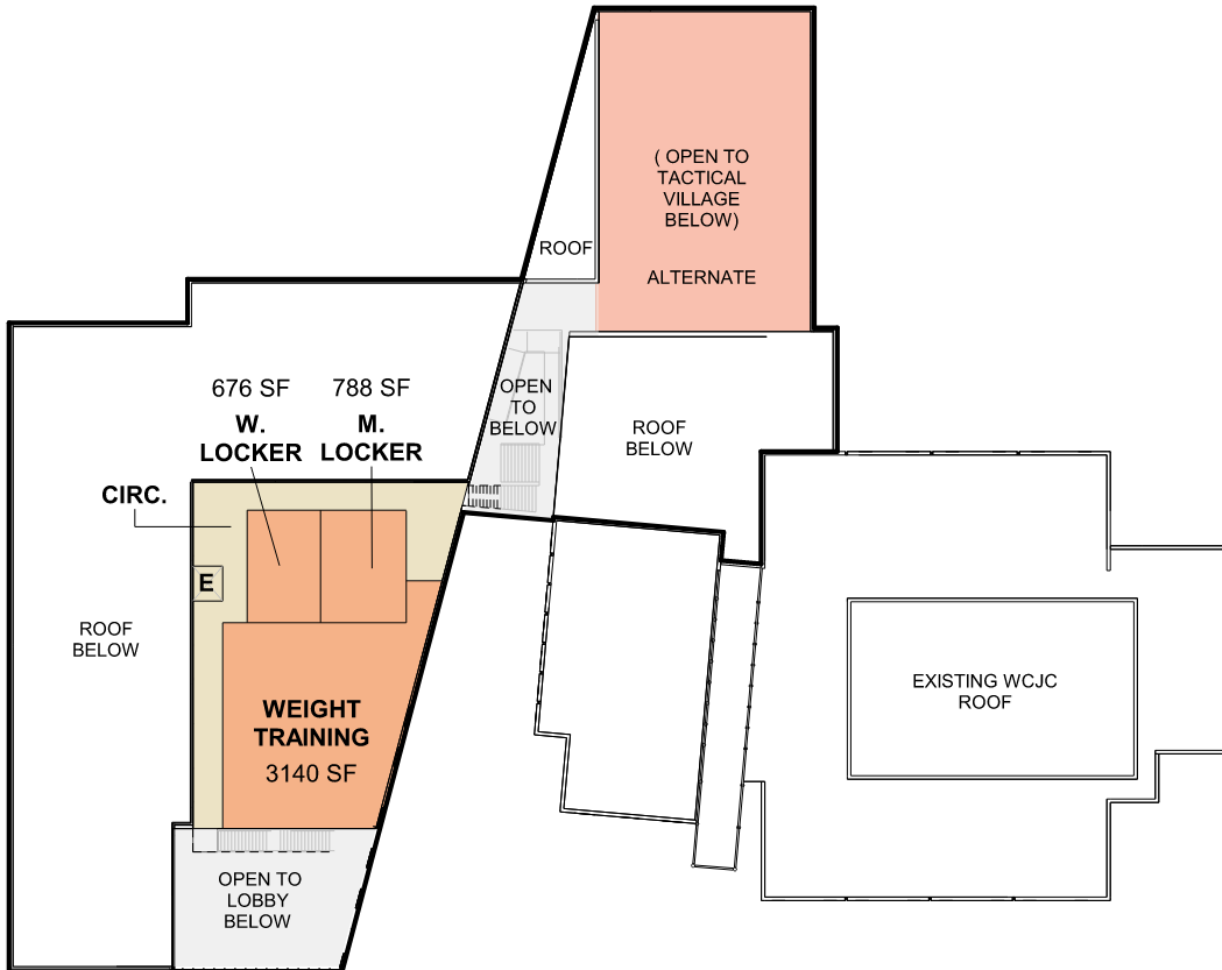

- **Second floor**



Option 2

MAIN TCSO BUILDING ADDITION TO TCC BUILDING

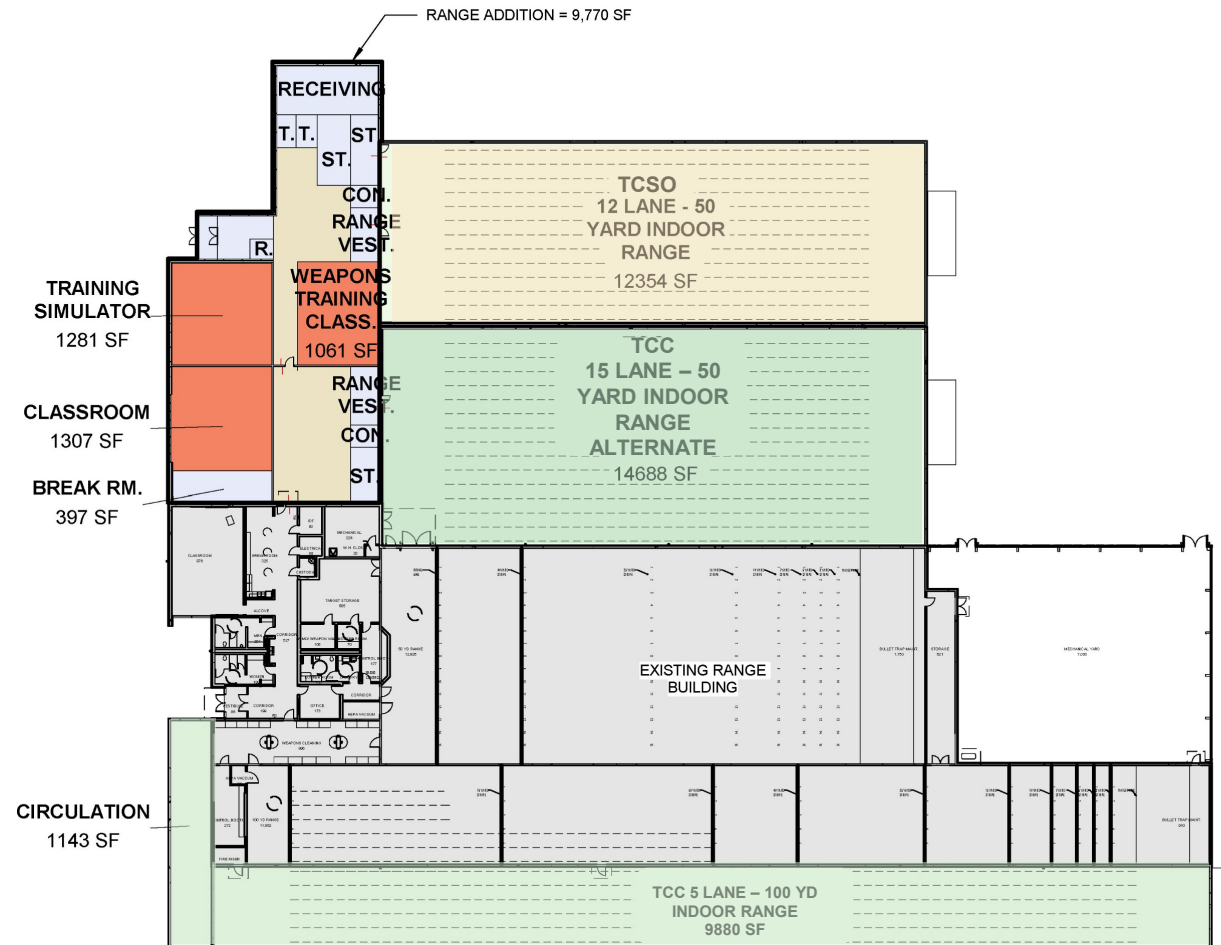

- Range Building 9,770 sf
- Classrooms
- Range Storage
- Training Simulator
- Future 12 lane 50-yd TCSO range
- Future TCC 15 lane 50-yard range
- Future TCC 5 lane 100-yard range

Option 2

MAIN TCSO BUILDING ADDITION TO TCC BUILDING



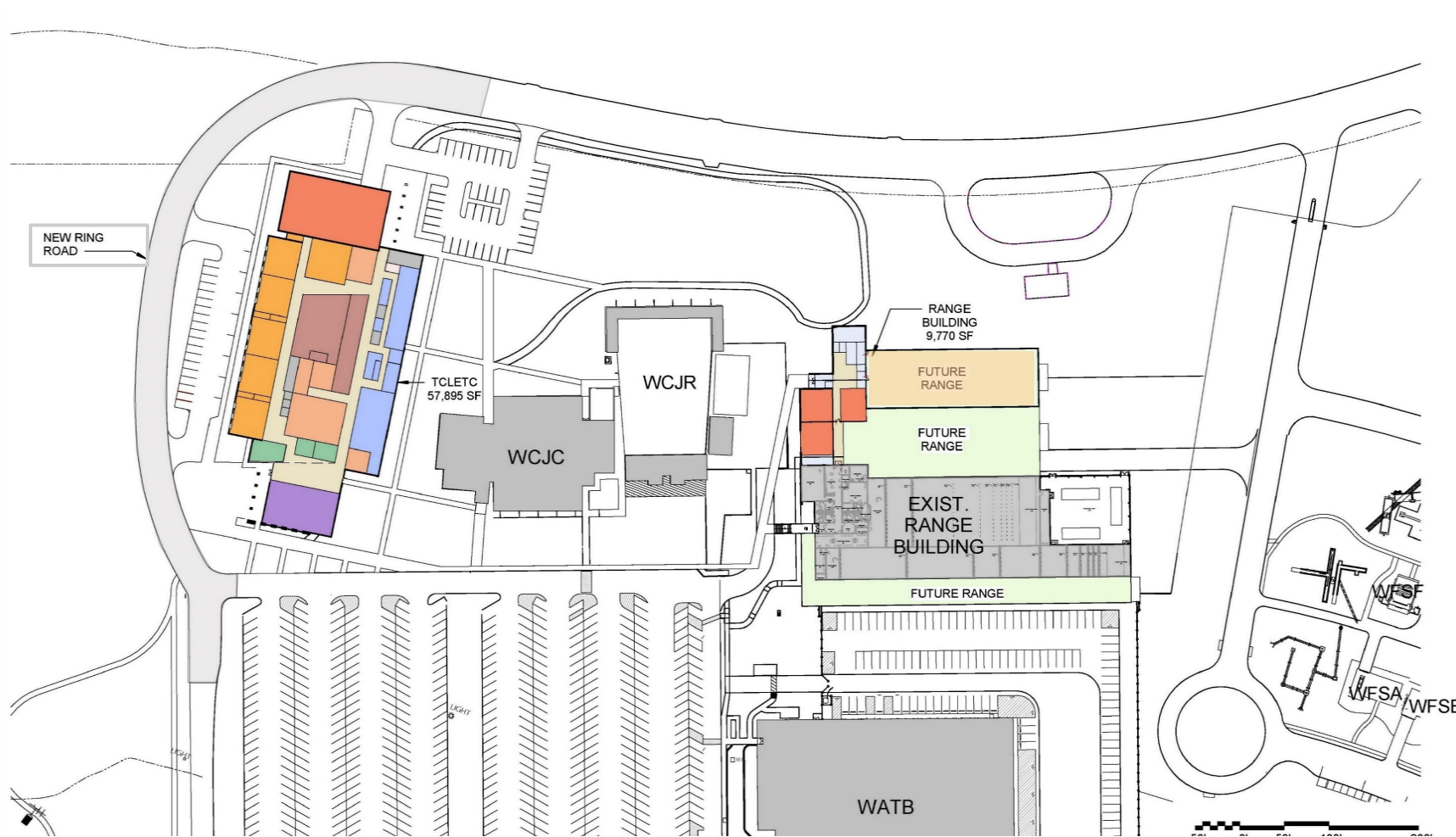

- Main TCSO Building new building
- Range Building addition to existing building

Option 3

MAIN TCSO NEW STAND-ALONE BUILDING

Option 3

MAIN TCSO NEW STAND-ALONE BUILDING

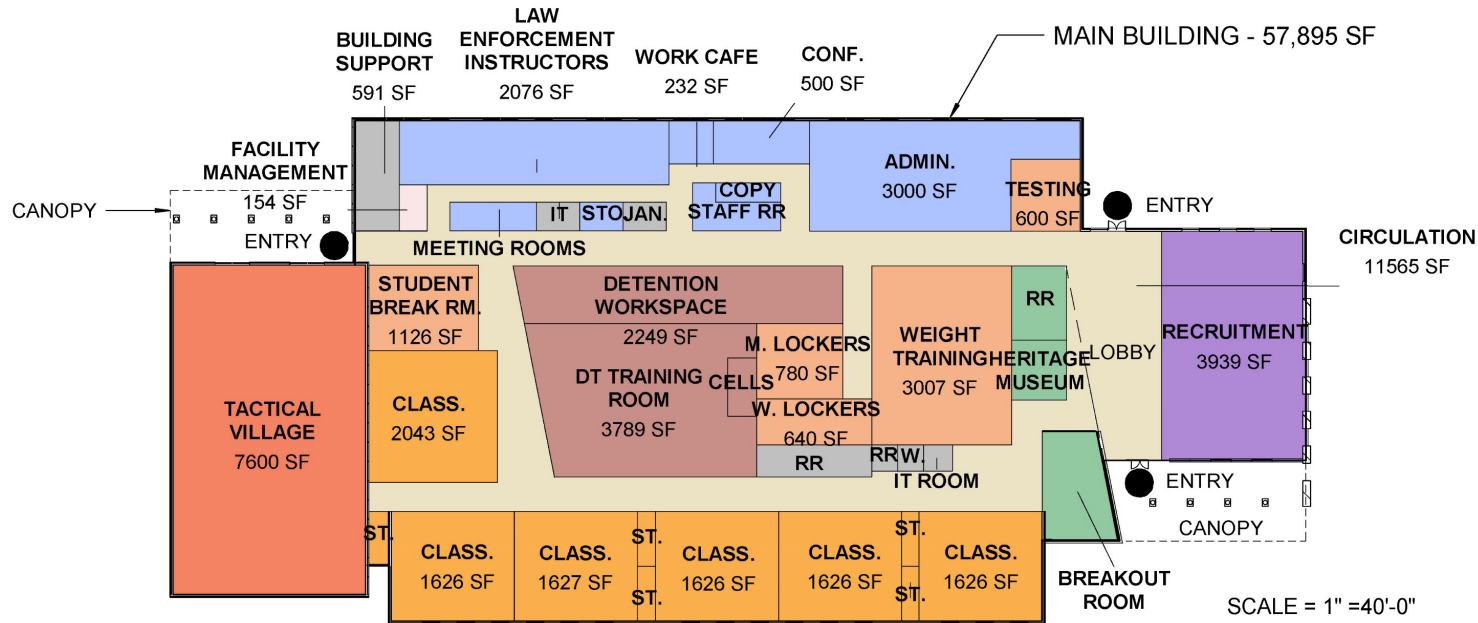

- Main Building 57,895 sf
- Freestanding building
- Modifies TCC ring road

Option 3

MAIN TCSO NEW STAND-ALONE BUILDING

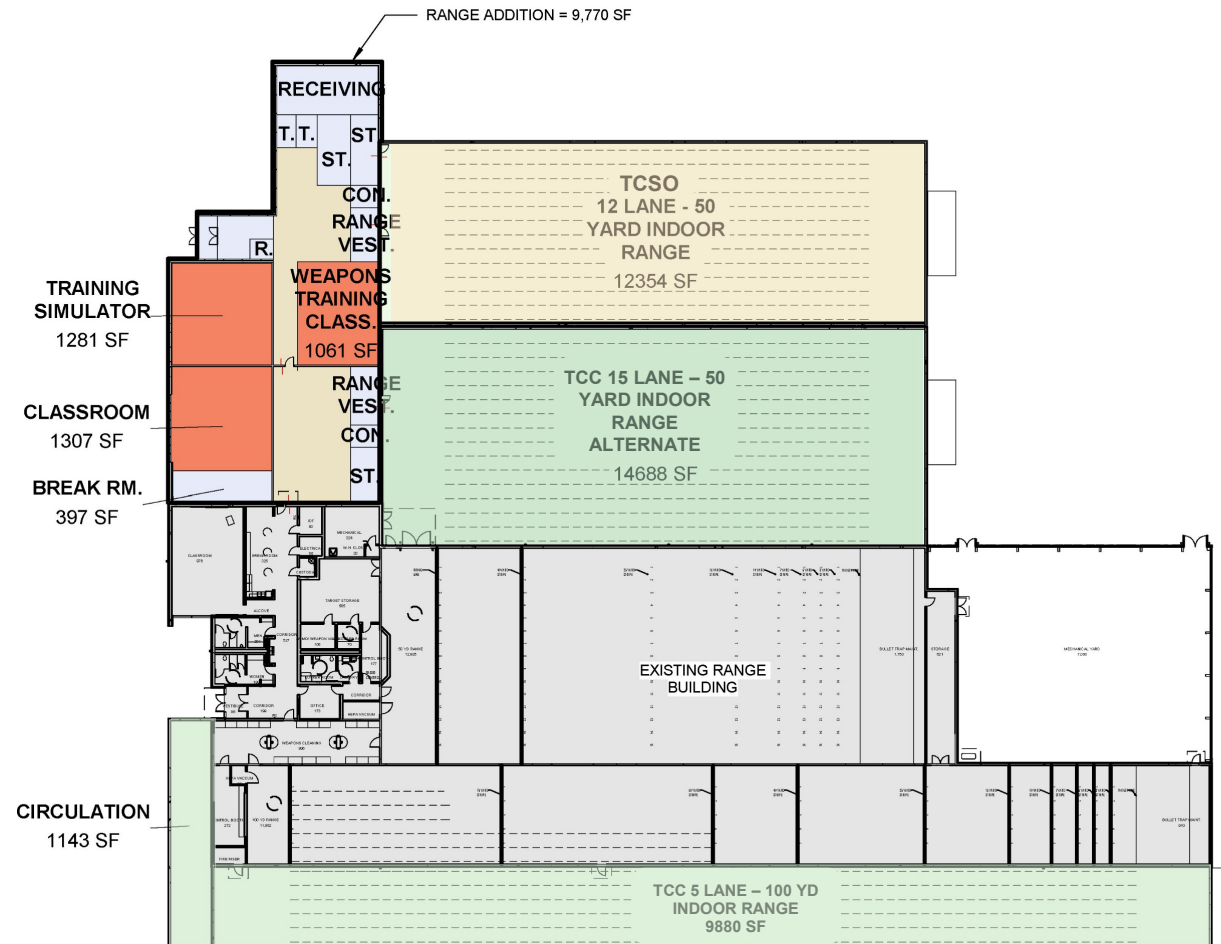

- Range Building addition 9,770 sf
- Future ranges possible
- Addition to existing TCC range building

Option 3

MAIN TCSO NEW STAND-ALONE BUILDING



Option 1

RESOURCE CONNECTION

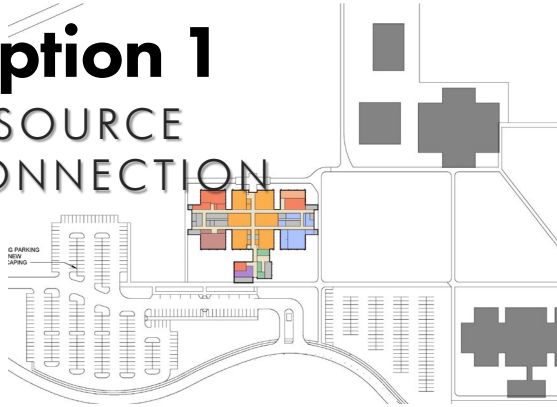

Option 2

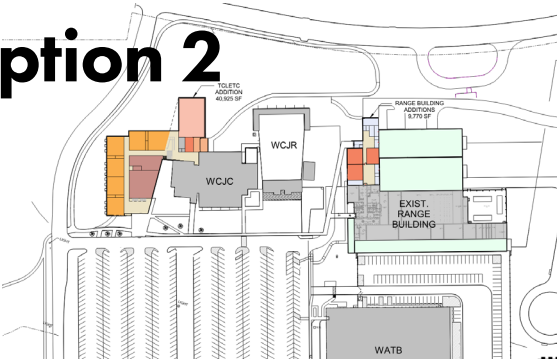

Option 3

TCC NW CAMPUS

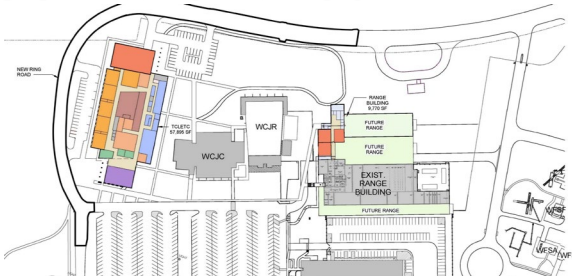

Option 1

Existing 1500 Renovation
41,700 sf \$19,596,665

FFE \$2,090,560

Add Alternates

Exterior Enhancement
41,700 sf \$3,846,074

Building 1500 Infill
2,600 sf \$2,093,520

SWAT at Building 5051
1,860 sf \$914,942

Range Building with 12 Lane
50-Yd Range @ TCC
22,124 sf \$17,969,499

Tactical Village
5,582 sf \$3,893,445

Option 2

Main TCSO Building
Addition to TCC Building
40,925 sf \$35,113,650

FFE \$2,082,208

Add Alternates

Range Building
9,770 sf \$7,518,015

12 Lane 50-Yd Range
12,354 sf \$10,451,484

15 Lane 50-yd Range
16,488 sf \$13,948,848

5 Lane 100-yd Range
11,023 sf \$8,730,216

Tactical Village
5,582 sf \$3,893,445

Recruiter & Background
1350 sf \$1,158,300

Option 3

Main TCSO New Stand-
alone Building
57,895 sf \$51,671,288

FFE \$2,343,904

Add Alternates

Range Building
9,770 sf \$7,518,015

12 Lane 50-Yd Range
12,354 sf \$10,451,484

15 Lane 50-yd Range
16,488 sf \$13,948,848

5 Lane 100-yd Range
11,023 sf \$8,730,216

Tactical Village
5,582 sf \$3,893,445



OPTION 1

RESOURCE CONNECTION



Pros

- Most functions in single location
- Uses existing facilities and established location
- Meets SO project goals
- Quartermaster close proximity to main functions
- No flood plain concerns
- Convenient parking
- TC procurement process
- Future expansion possible

Cons

- Lower ceiling heights in existing building
- Column layout in existing building

OPTION 2

MAIN TC SO BUILDING ADDITION TO TCC BUILDING

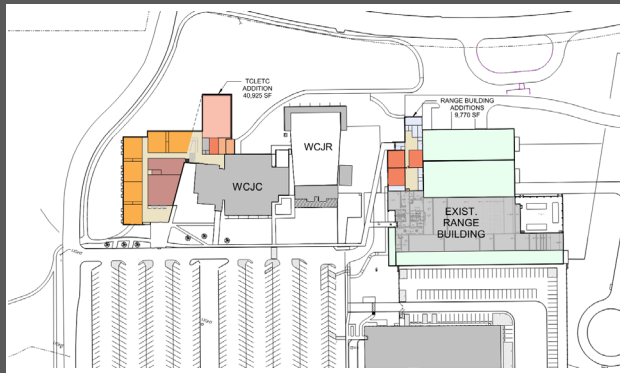

Pros

- Existing education-based functions
- Existing parking adjacent to LETC functions
- Use of existing TCC buildings

Cons

- Minimal use of existing TCC range
- Added cost for TCC requested ranges
- LETC function distributed between two sites
- Shared parking with TCC somewhat remote
- TCC procurement process time constraints
- Adjacent school zones
- Limited future expansion possibilities

OPTION 3

MAIN TC SO NEW STAND-ALONE BUILDING

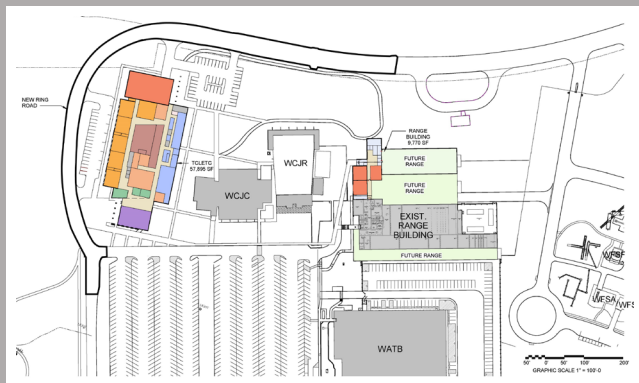

Pros

- Existing education-based functions
- New main classroom building dedicated to LETC functions
- Expanded existing TCC range building with some share functions
- Use of existing TCC buildings

Cons

- Limited use of existing TCC buildings
- TCC procurement process time constraints
- Adjacent school zones
- Increased site cost to relocate existing TCC ring road
- Possible flood plain issues
- Limited future expansion possibilities

QUESTIONS?



KOMATSU
ARCHITECTURE



THANK YOU

3880 HULEN ST., STE. 300

FORT WORTH, TX 76107

817.710.1341



KOMATSU
ARCHITECTURE